

DEC Concrete Floor Fitting Instructions



1 Locate DEC in the corner to which it is going to be finally positioned and mark lines around the outer edge.



2 Excavate the floor to a sufficient depth to accept DEC.



3 Ensure DEC fits neatly into the recess. Mark shower trap position.



4 Remove DEC. It will be necessary to remove an area to sufficient depth under the outlet position to accommodate the shower trap.
(Approx. trap depth 95mm x 110mm).



METHOD 1 (as shown in points 5 & 5a) - Set the trap body into the floor. Place the trap flange into the DEC ensuring it finishes flush with, or just below the surface on which the sheet flooring is to be laid. Secure flange to the DEC, there are a number of countersunk indentations in the flange to assist with this. Connect trap to waste pipe for outflow drain.

METHOD 2 - Fully assemble the trap to the DEC (as described above) before placing in position, also attaching a length of pipework ready for connection to the waste / soil pipe.

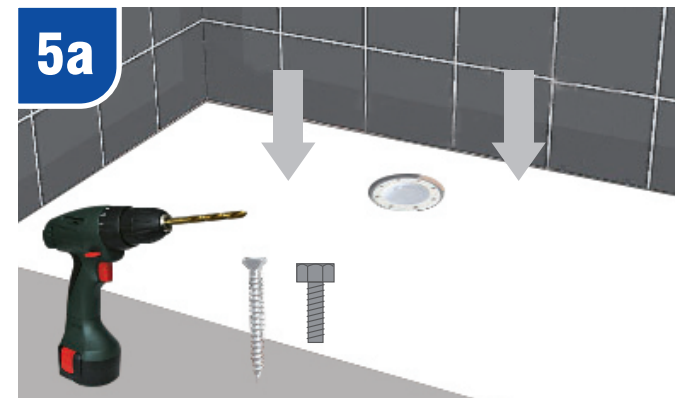

DEC Concrete Floor Fitting Instructions

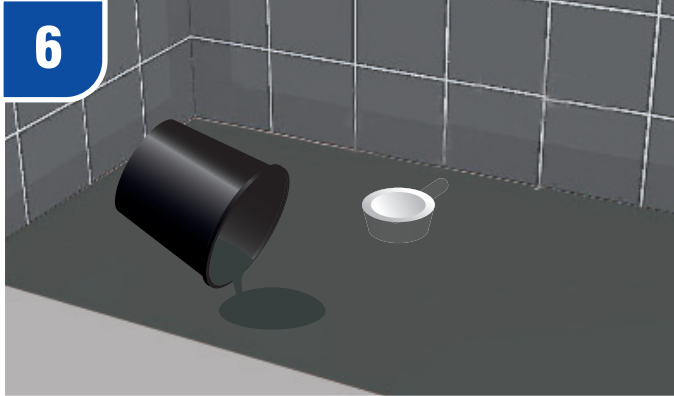

Apply a 'weak' sand and cement mix to the proposed area. This will ensure DEC is fully supported.

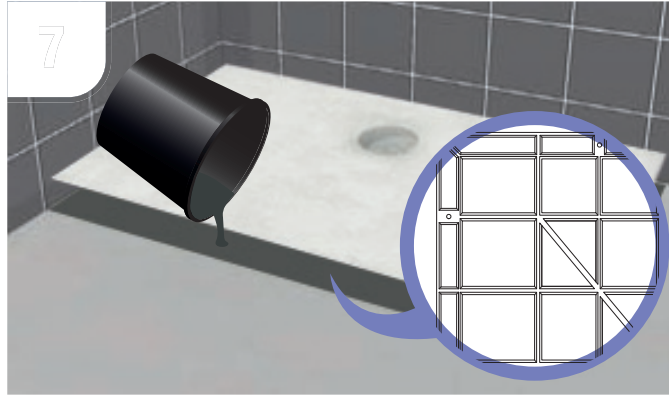

Square ribbed underside allows DEC to settle on a cement or screed base eliminating slippage during installation. Carefully place DEC into position. Check levels in both directions, gently tap DEC down until level on all 4 sides. It may be necessary to add more sand and cement, do this by slightly lifting the DEC and adding in the mixture. Gently tap again until level on all 4 sides.

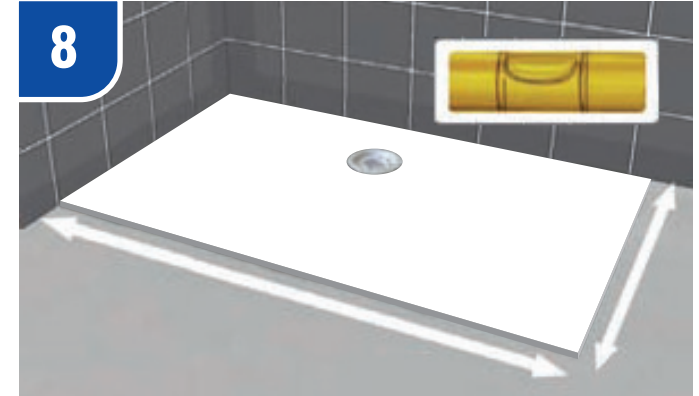

It is **important** that DEC is level on all 4 sides when fitted and then left to set.



At this stage you will now be ready to bond into position the relevant coverings and floor coverings.

NOTE: Bond vinyl sheet flooring to the floor using a 2 part water resistant adhesive. All flooring should be installed in accordance with the manufacturers guidelines.



Once the floor covering is laid, screw into position the trap clamping ring using the bolts provided, ensuring the inner cup and dip tube can still be removed. Fit the shower traps push on cover plate.

Note: If fitting a pumped trap follow the above instructions in conjunction with the pump installation instructions.